

REVISION HISTORY				
REV	DATE	DESCRIPTION	ECO	BY
A	8/23/2012	PRODUCTION RELEASE	13859	SV

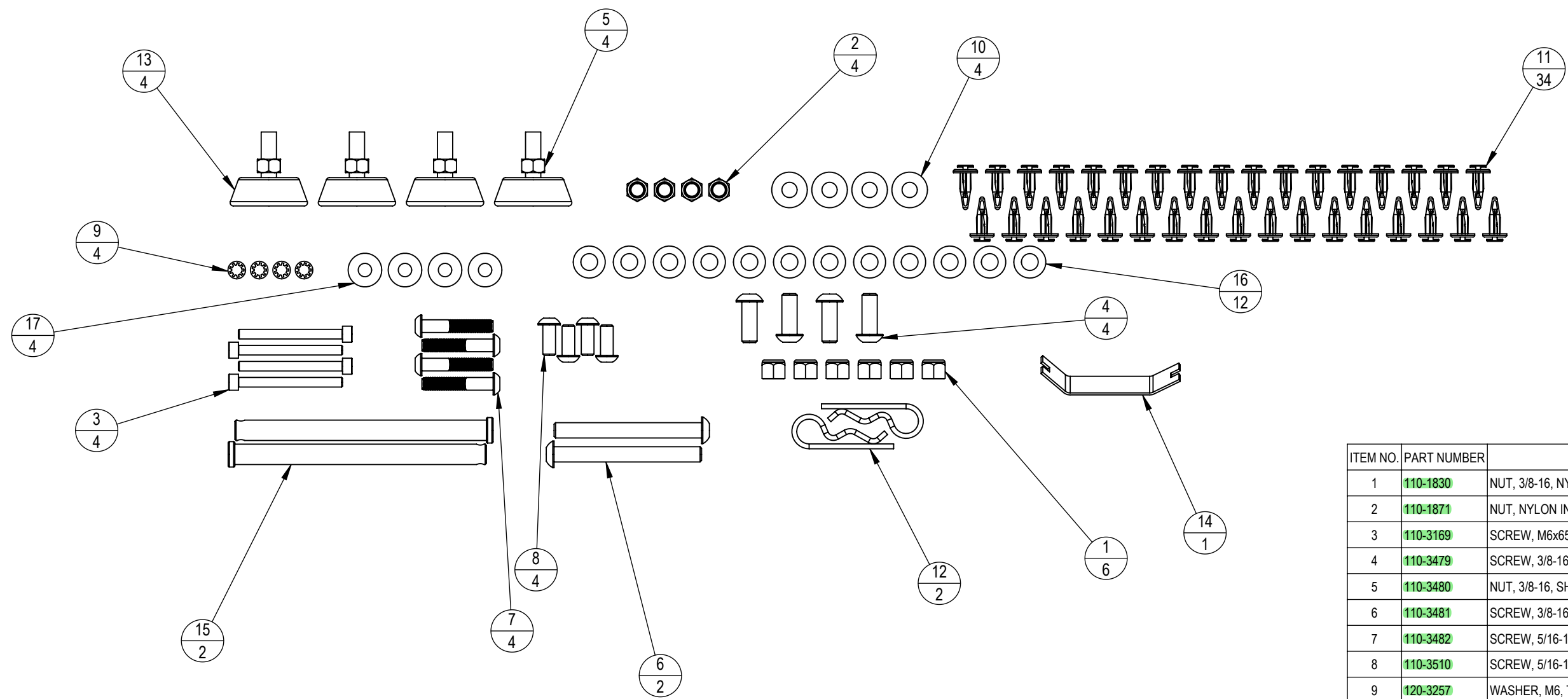

ITEM NO.	PART NUMBER	DESCRIPTION	QTY.
1	110-1830	NUT, 3/8-16, NYLOK HEX	6
2	110-1871	NUT, NYLON INSERT	4
3	110-3169	SCREW, M6x65, SHC, HE, ISO4762	4
4	110-3479	SCREW, 3/8-16, 1", BHCS, CS, ECB	4
5	110-3480	NUT, 3/8-16, SHN, CS, ZP, GR 5	4
6	110-3481	SCREW, 3/8-16, 3 5/8", BHCS, AS, ZP	2
7	110-3482	SCREW, 5/16-18, 1 3/4", BHCS, AS, ZP	4
8	110-3510	SCREW, 5/16-18, 3/4", BHCS, AS, ECB	4
9	120-3257	WASHER, M6, TEETH, 0.6 THICK	4
10	120-3330	WASHER, PLAIN, ID: .3125", OD: .875", TH: .07", CS, ECB	4
11	140-3493	RIVET, DRIVE, REMOVABLE, Ø.25 X .098"-.315"	34
12	140-3494	PIN, COTTER, Ø.12" WIRE, 1/2"-5/8" SHAFT, CS, ZP	2
13	140-3495	FEET, 3/8-16 SCREW, 1.93" BASE	4
14	140-3508	TOOL, PULLER, RIVET, DRIVE, E-SM	1
15	711-3339	PIN, TRANSPORTATION, SM	2
16	731-0367	WASHER, PLAIN, M10	12
17	740-7842	WASHER, 8.4mmID X 21mm OD X 1.6mm THK	4

DOCUMENT STATUS:

NOTICE OF PROPRIETARY INFORMATION
 THIS DOCUMENT SHALL NOT BE REPRODUCED NOR SHALL THE INFORMATION CONTAINED HEREIN BE USED BY OR DISCLOSED TO OTHER EXCEPT AS EXPRESSLY AUTHORIZED BY CORE INDUSTRIES, INC., D.B.A. STAR TRAC.

CLASS OF WORK	UNLESS OTHERWISE SPECIFIED DIMS ARE IN mm. TOLERANCES FOR MEASURE OF LENGTH ARE:							ANGLES = ±2°		
	0.5 to 3	>3 to 6	>6 to 30	>30 to 120	>120 to 400	>400 to 1000	>1000 to 2000	>2000		
FINE	±0.05	±0.05	±0.1	±0.15	±0.2	±0.3	±0.5	----		
MEDIUM	±0.1	±0.1	±0.2	±0.3	±0.5	±0.8	±1.2	±2		
COARSE	±0.2	±0.3	±0.5	±0.8	±1.2	±2	±3	±4		
VERY COARSE	----	±0.5	±1	±1.5	±2.5	±4	±6	±8		

MATERIAL
SEE BOM

FINISH
SEE BOM

VENDOR: N/A

P/N: N/A

THIRD ANGLE PROJECTION

DRAWN: SV
 CHECKED:
 APPROVED:

INITIAL: SV
 DATE: 05/14/2012

U.O.M.: MM

CORE INDUSTRIES, INC. DBA

14410 Myford Road
Irvine CA 92606

STARTRAC PART NO: **711-3346**

TITLE: **KIT, HARDWARE, STARMILL**

SCALE: 1:3 | SHEET 1 OF 1 | SHEET SIZE: B

REV: **A**